



2 Queens Road, Bromley | £165,000 Leasehold |

This unique purpose built studio apartment is situated in an enviable location on the top floor of a commercial building in the heart of Bromley town centre with it's wide array of shops, bars and restaurants and is also equal walking distance from two main line stations.



- Allocated parking
- Heart of the town centre.
- Studio apartment.
- Top floor of a commercial building.
- Unrivalled views across Bromley

Entrance Hall

Studio Room 22.2 x 14.1 (6.77 x 4.3)

kitchen 8.10 x 8.2 (2.47 x 2.5)

Bathroom

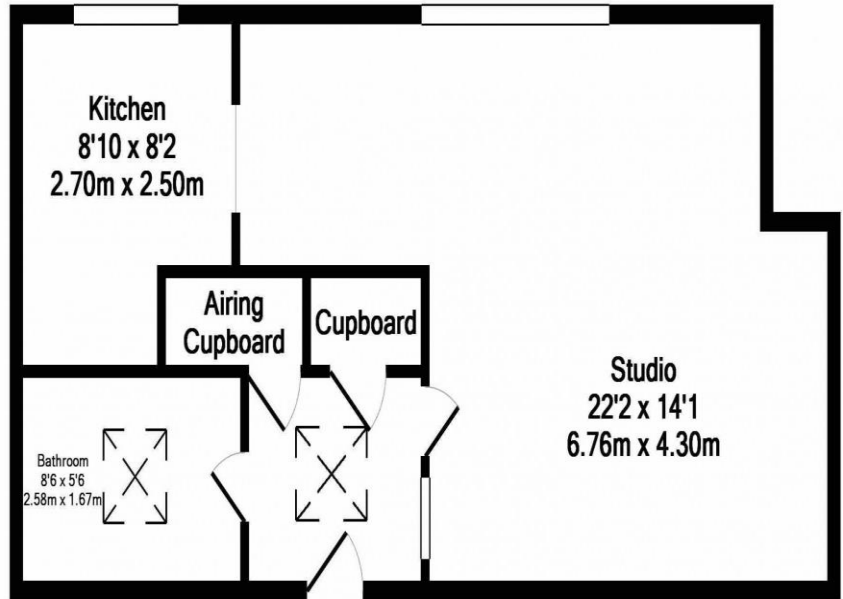

Total Approx. Floor Area 424 Sq.Ft. (39.4 Sq.M.)

Whilst every attempt has been made to ensure the accuracy of the floor plan contained here, measurements of doors, windows, rooms and any other items are approximate and no responsibility is taken for any error, omission, or mis-statement. This plan is for illustrative purposes only and should be used as such by any prospective purchaser. The services, systems and appliances shown have not been tested and no guarantee as to their operability or efficiency can be given
Made with Metropix ©2017

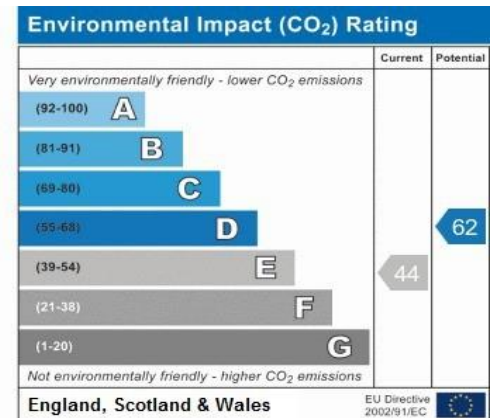
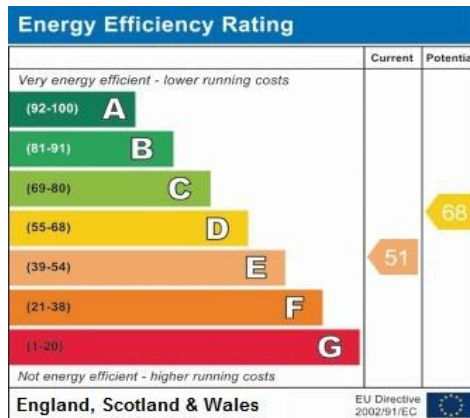

Directions:

NOTICE. Whilst every effort has been made to ensure the accuracy of these sales details, they are for guidance purposes only and prospective purchasers or lessees are advised to seek their own professional advice as well as to satisfy themselves by inspection or otherwise as to their correctness. Some images have been taken using a wide angle lens. No representation or warranty whatever is made in relation to this property by Coady Phillips or its employees nor do such details form part of any offer or contract.